



WALKER | MACY

# CCC CONCEPT MASTER PLAN CAMPUS CONCEPTS

COLLEGE COUNCIL  
10.21.2022

## **TODAY'S AGENDA**

- **Strategies for Student Success**
- **What We've Heard**
- **Oregon City Campus Concepts**
  - Campus Core
  - East Campus
  - Other Opportunities
- **Harmony Campus Concepts**
- **Wilsonville Campus Concepts**
- **Next Steps**

**PROJECT GOALS:**

# **PLANNING FOR THE FUTURE**



**VISION AND  
DIRECTION FOR  
CAMPUSES**



**10-YEAR  
GROWTH/CHANGE**



**FURTHER EQUITY  
& SUSTAINABILITY**



**ADAPT FOR  
FUTURE  
LEARNING**

# SCHEDULE

2022

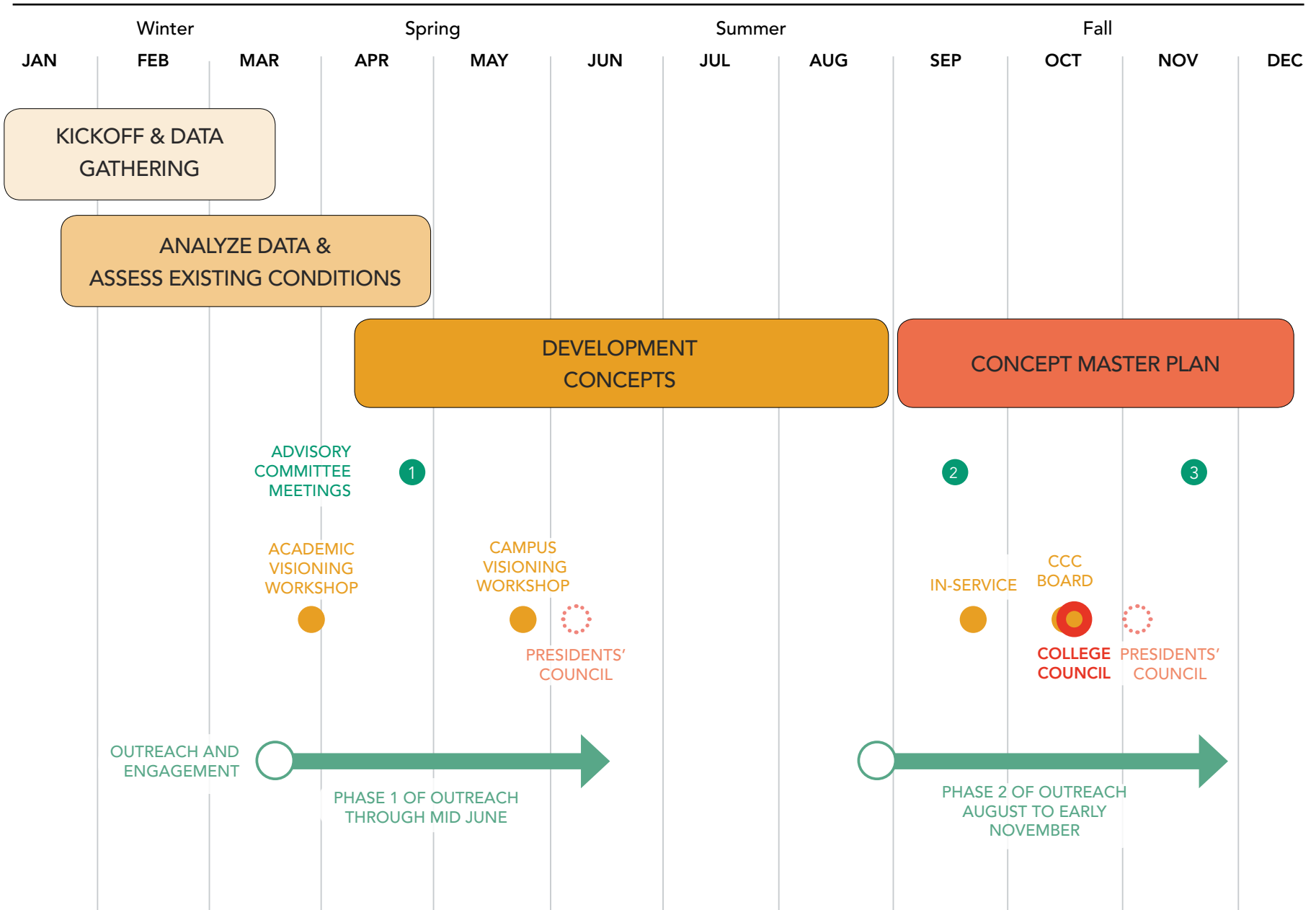



## STRATEGIC ENROLLMENT TARGETS

Campus	2019 Enrollment	Target 2024/25	Target 2030/31
Oregon City	10,891	10,900	13,080
Harmony	2,318	2,320	2,784
Wilsonville	1,099	1,100	1,320
Off-Campus	5,675	5,680	6,816
Total	19,983	20,000	24,000

## STRATEGIES TO INCREASE ENROLLMENT

- Enhance **admissions, onboarding, advising, and retention**
- Create **clear pathways to education** for systematically oppressed populations
- Support students with **basic needs**



## HIGHER EDUCATION TRENDS

- Spaces to Support & Convey **Belonging** and **Student Engagement**
- **Remote/Hybrid** Technology and Flexibility
- Student **Support Spaces and Services**
- **Office Optimization** and Hybrid Work
- Focus on **CTE and Workforce** Programs
- Areas for **Collaborative Partnerships & Community Services**
- **Innovative New Programs**



## CHANGING MODALITY & SPACE UTILIZATION

FULLY IN-  
PERSON

HYBRID/  
HYFLEX

FULLY  
ONLINE

CURRENT

46%

10%

44%

### APPROACHES:

- Block scheduling
- Sharing classrooms between departments
- Adapting classrooms to meet changing student needs





## CREATIVE ADAPTATIONS OF SPACE

- Contemporary **Teaching and Learning** Environments
- **Hybrid Learning** Spaces
- Comfortable **Study & Gathering** spaces
- **Partnerships & Community Connections**



## PARTNERSHIPS & COMMUNITY CONNECTIONS

### OPPORTUNITIES

- Increase the number of **formal partnerships** in areas of **community need**
- Foster **connections with employers** and industry
- Demonstrate the **value of 2-year higher education**

### EXAMPLES

- Incubator Space
- Workforce Training
- Community / Nonprofit Partnerships
- Community Use / Recreation
- Affordable Housing
- Elder Care / Childcare







## IDEAS FOR MORE INCLUSIVE CAMPUSES

"Build with differing physical abilities in mind and make physical inclusivity a priority. Space for multi-cultural groups."

"More art with representation from artists and students of color!"

"Covered outdoor areas possibly with clear walls and possibly heated (radiant) for casual down-time and social interaction."

"The natural world is a powerful welcoming space but it may not feel safe for everyone. Allow it in with window placement, etc."



# SURVEY COMMENT MAP - OREGON CITY EXAMPLE

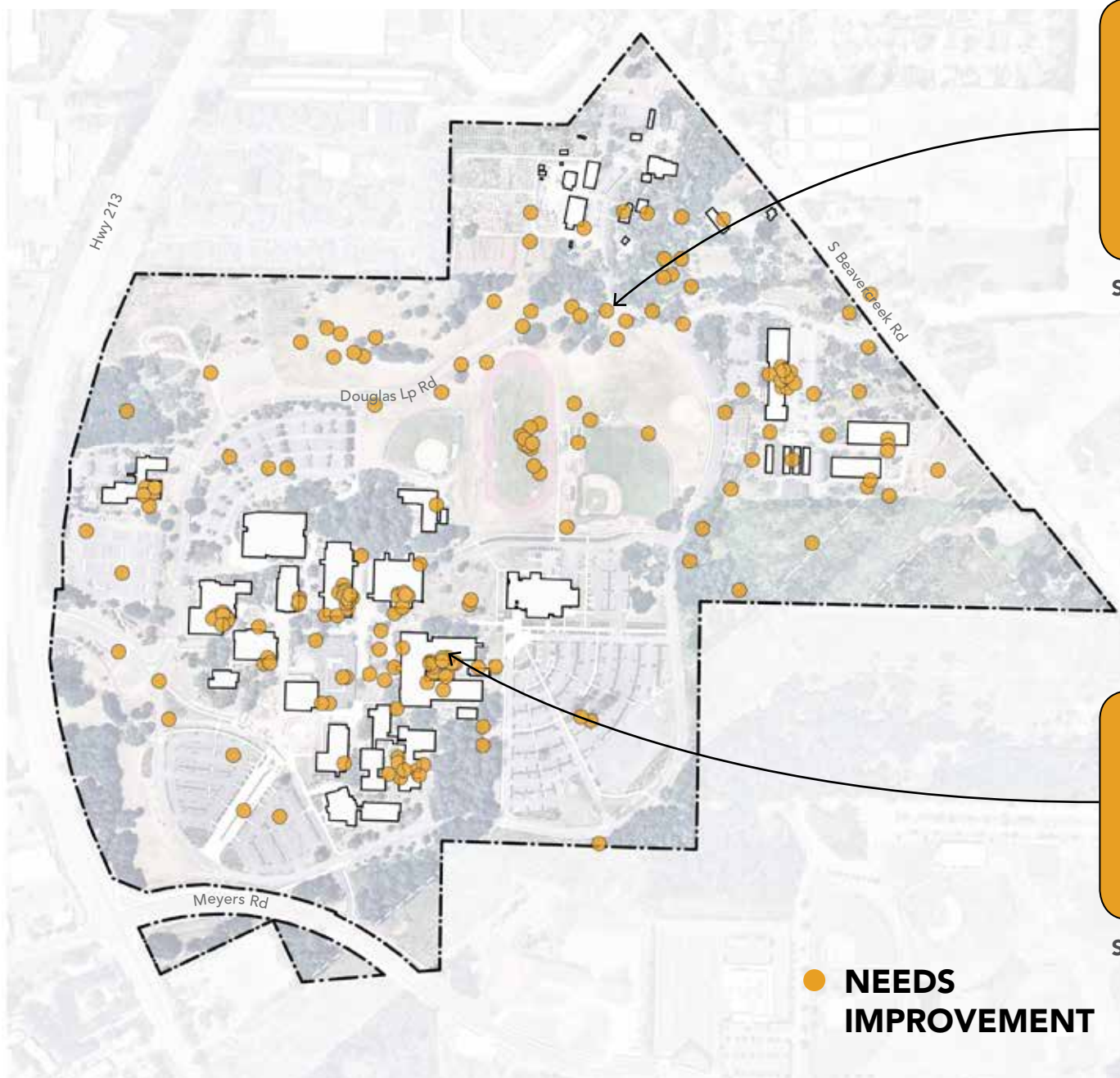

**"A lot of people walking around campus just walk on the street here, and that really doesn't feel the safest."**

**Student Comment: Douglas Loop**

**"Hallways feel and sound like a TWA passenger boarding bridge from the '70s."**

**Student Comment: Barlow Hall**

# THE 10-YEAR PLAN WILL...

- Provide spaces that **improve retention, student success, and sense of belonging**
- Be **adaptable** to meet future changes in educational delivery and technology
- Accommodate **regained and increased enrollment** based on strategic targets:
  - By 2024, regain 2019 enrollment
  - By 2030, attain 20% increase from 2019
- Prepare the college for **strategic partnership opportunities**





# OREGON CITY CAMPUS



# MASTER PLAN OPPORTUNITY AREAS

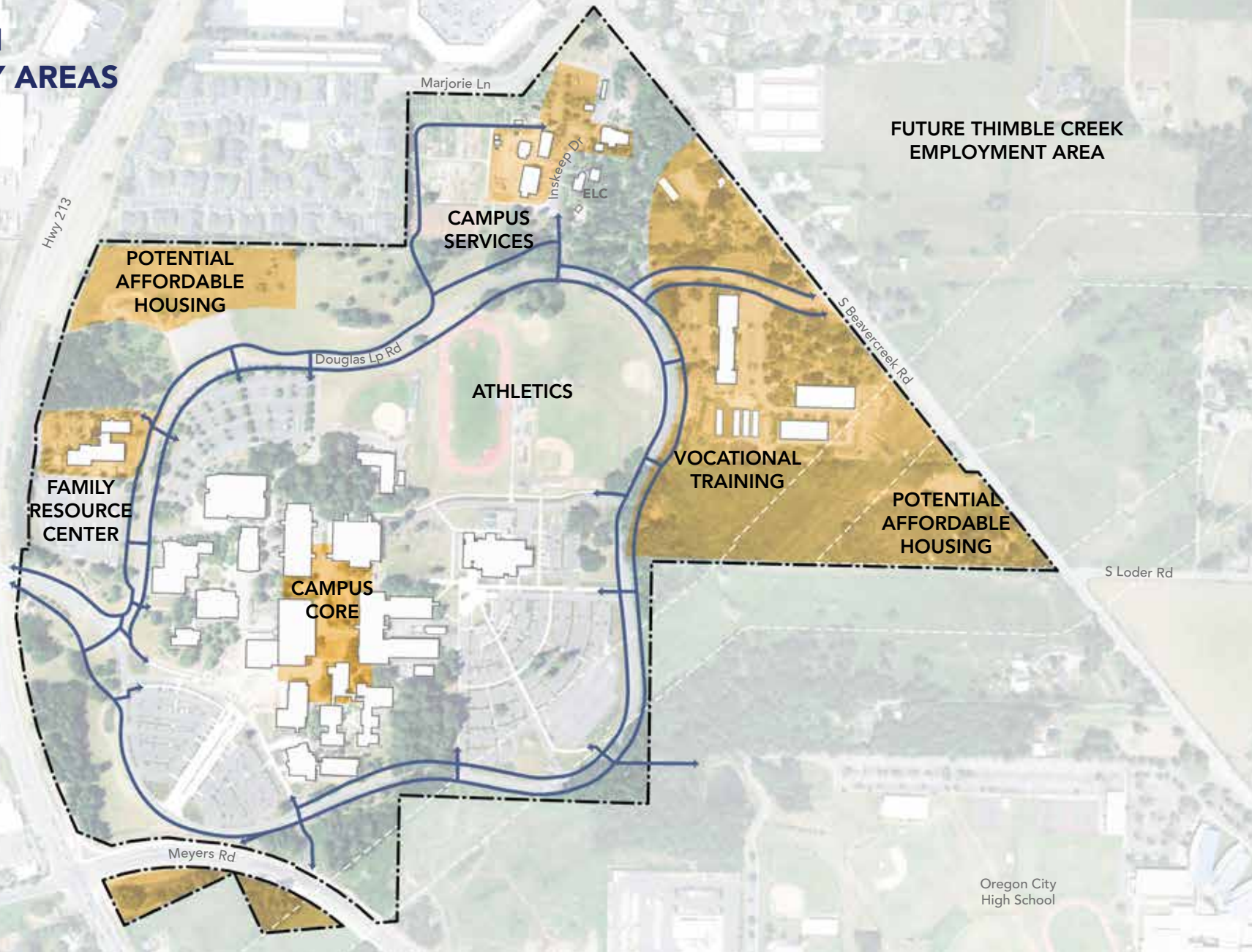

- CAMPUS BOUNDARY
- OPPORTUNITY SITES
- COMPLETE DOUGLAS LOOP PEDESTRIAN PATHS



# CAMPUS CORE - CENTRAL GATHERING SPACE

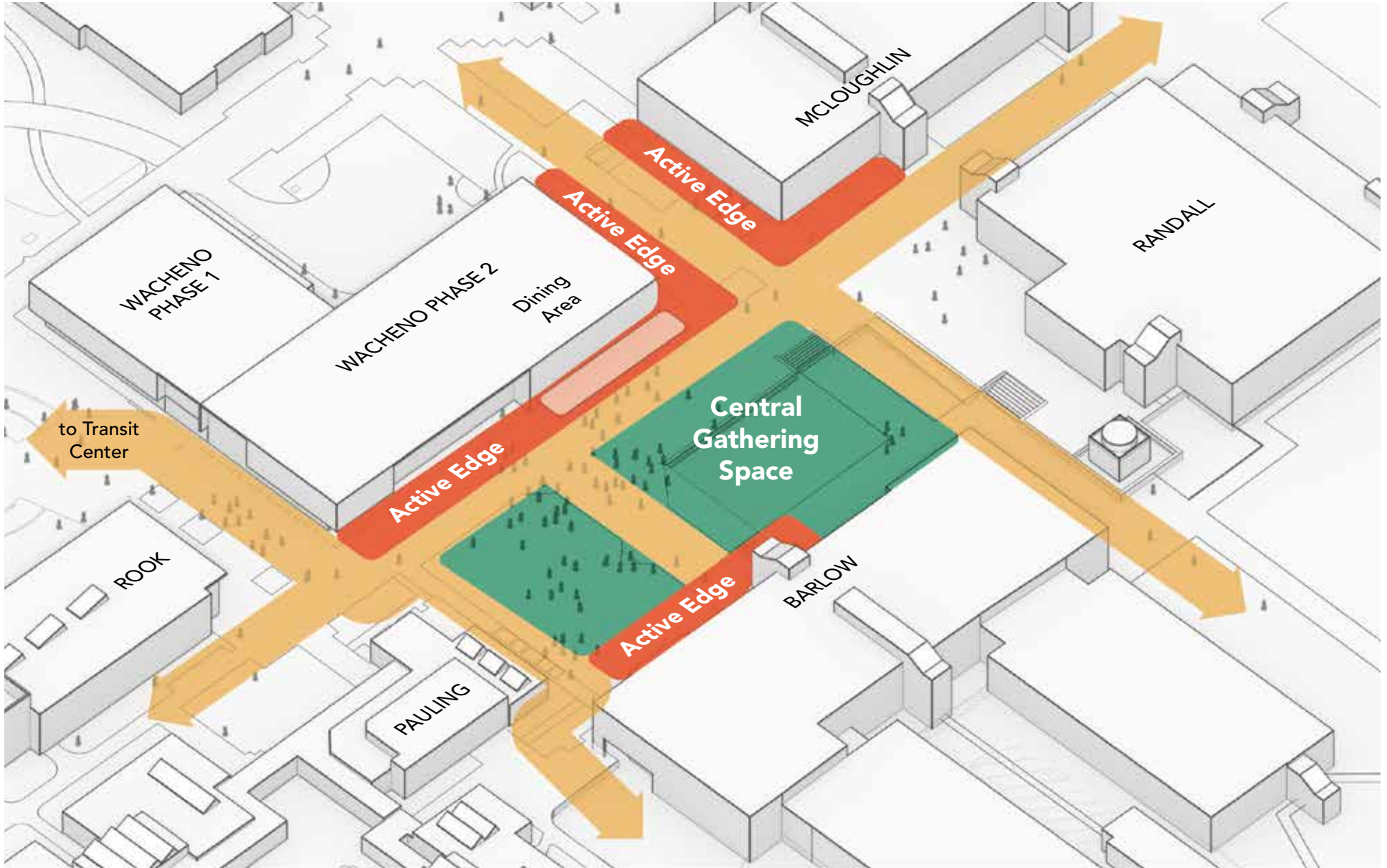



# ACTIVE CAMPUS HEART





# BUILDING ADAPTATION OPPORTUNITIES

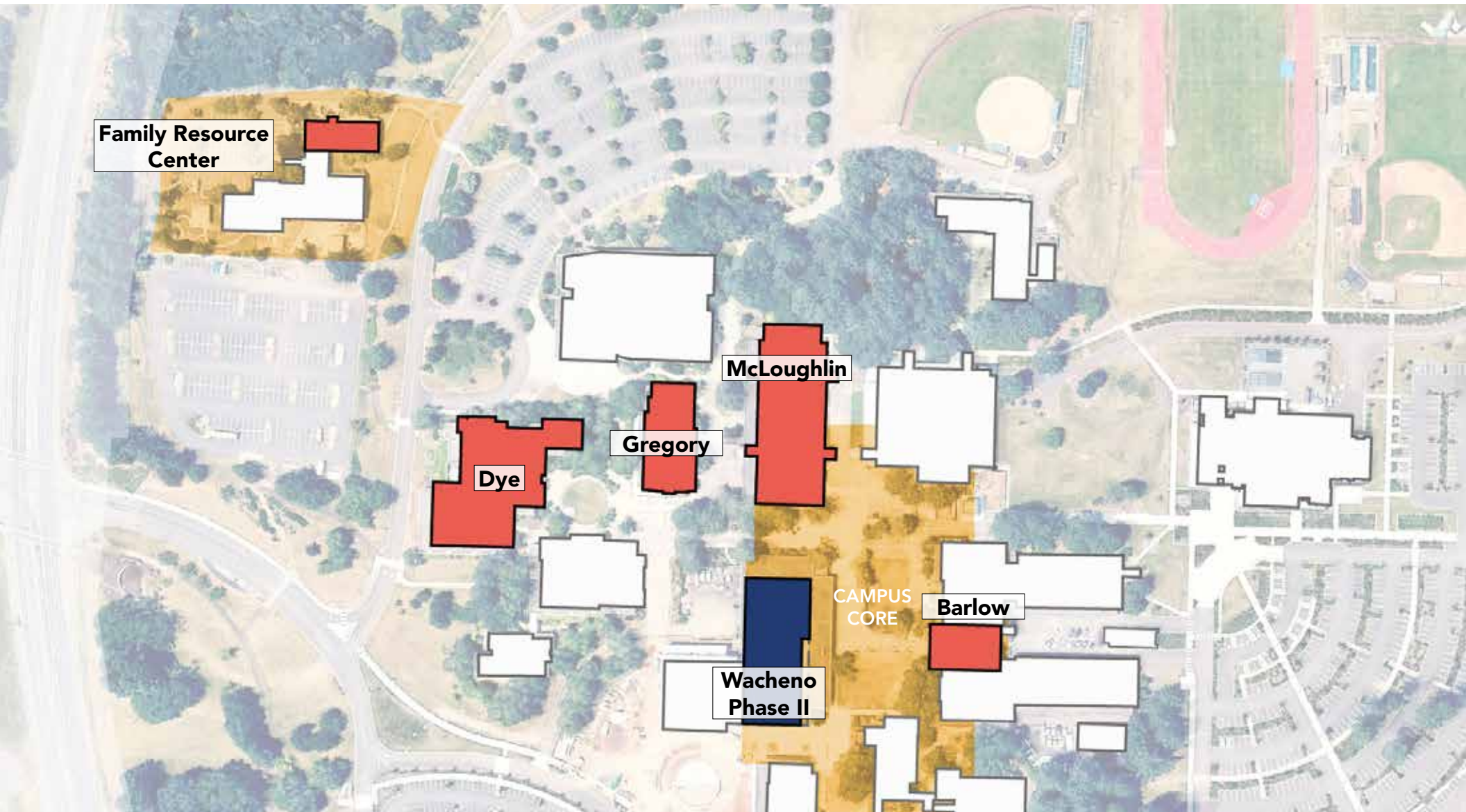

- CAMPUS BOUNDARY
- OPPORTUNITY SITE
- POTENTIAL BUILDING ADAPTATION
- NEW BUILDING

# WACHENO PHASE II

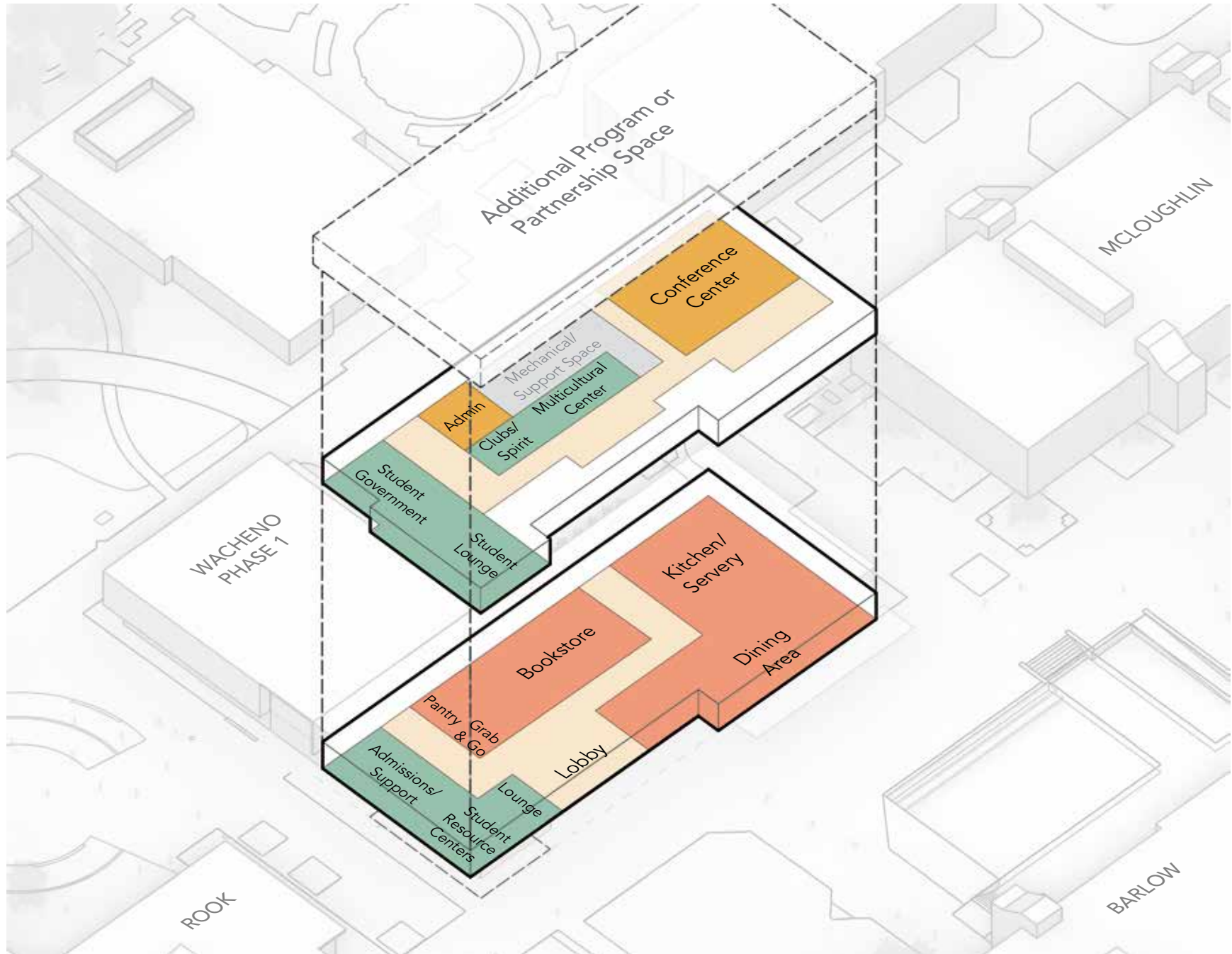



# MODERN TEACHING & LEARNING SPACES



# BUILDING ADAPTATION EXAMPLE: MCLOUGHLIN GROUND FLOOR

## Existing

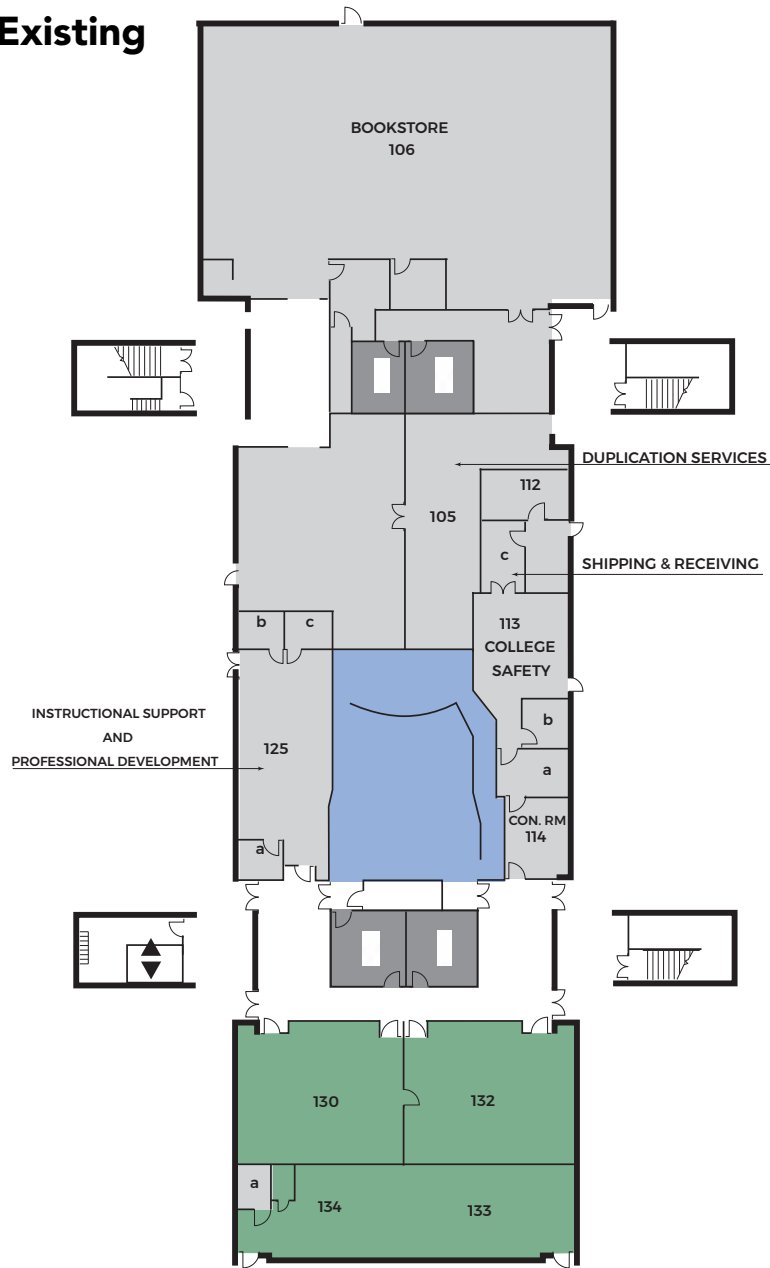

## Potential

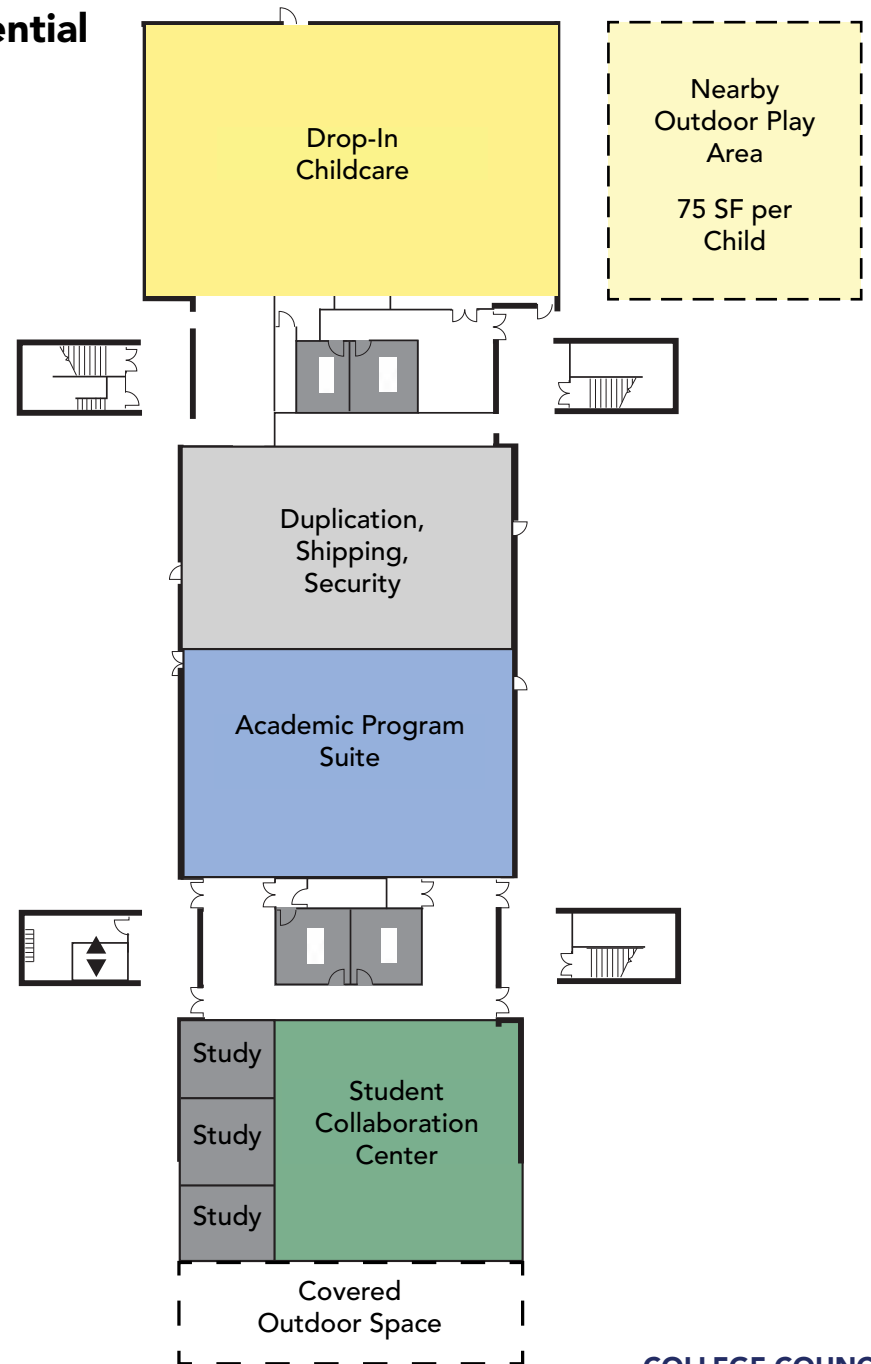

# BUILDING ADAPTATION EXAMPLE: MCLOUGHLIN SECOND FLOOR

## Existing

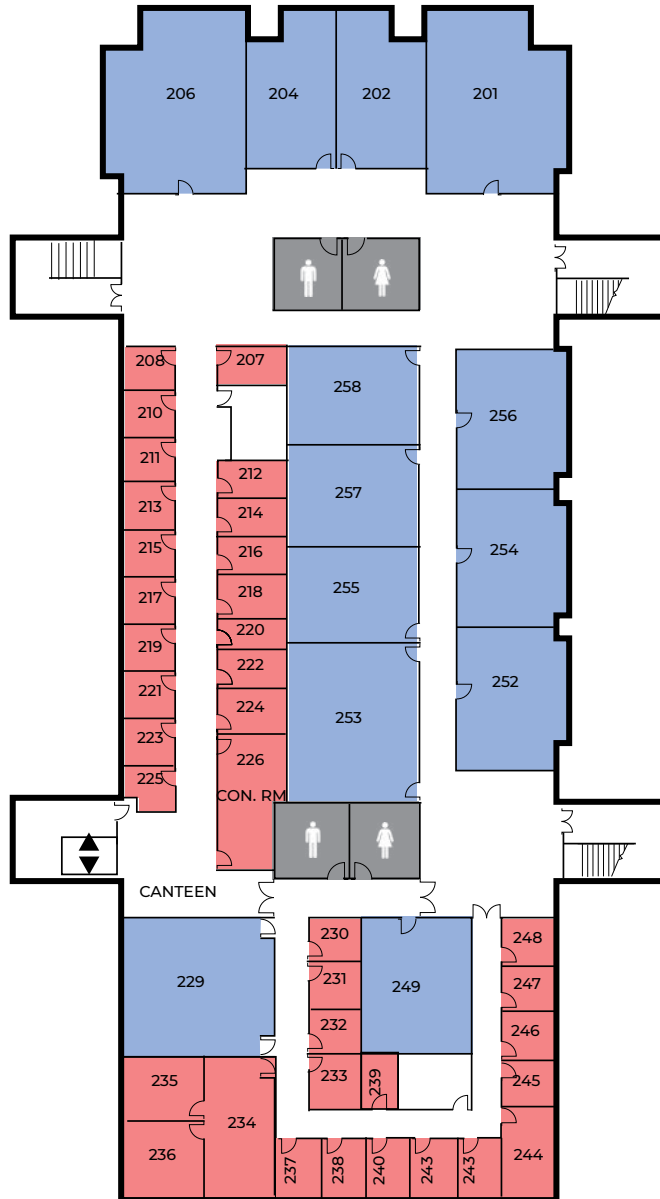

## Potential

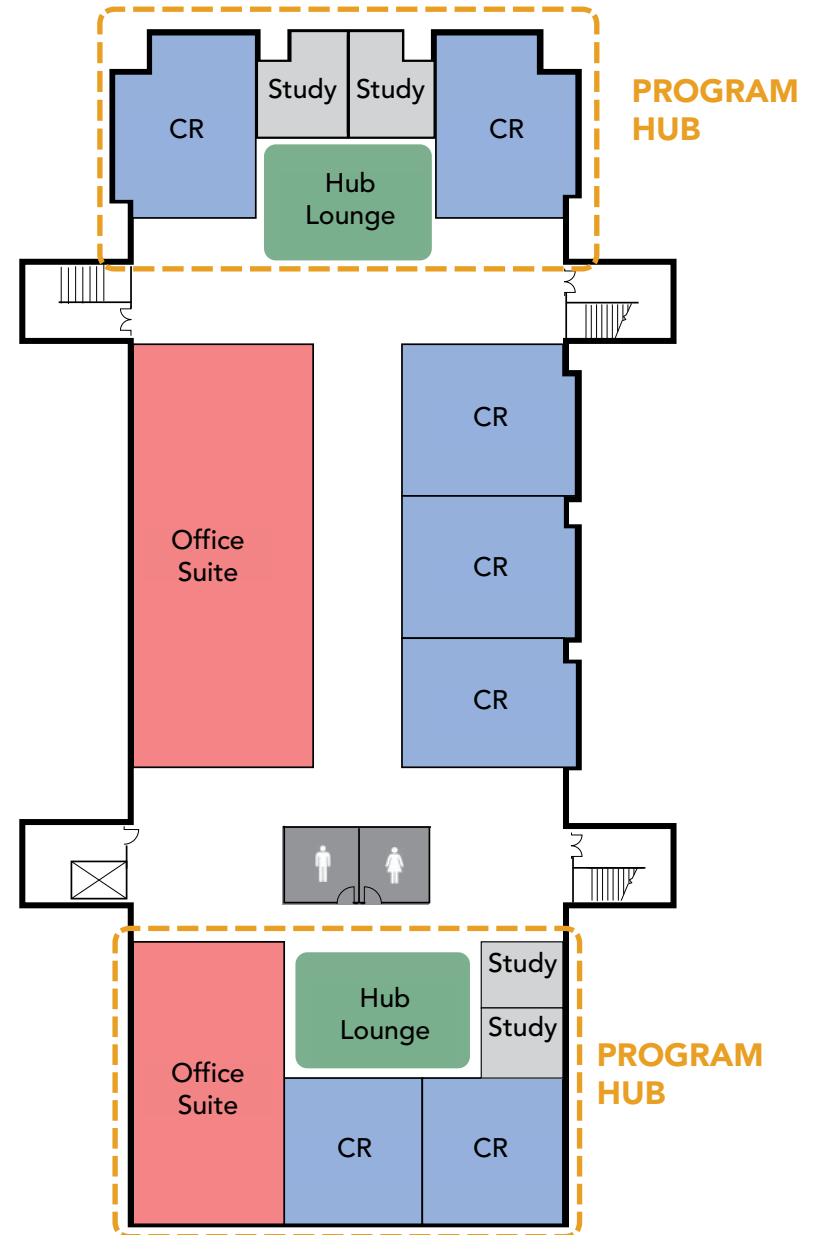

# BUILDING ADAPTATION EXAMPLE: BARLOW ENTRY

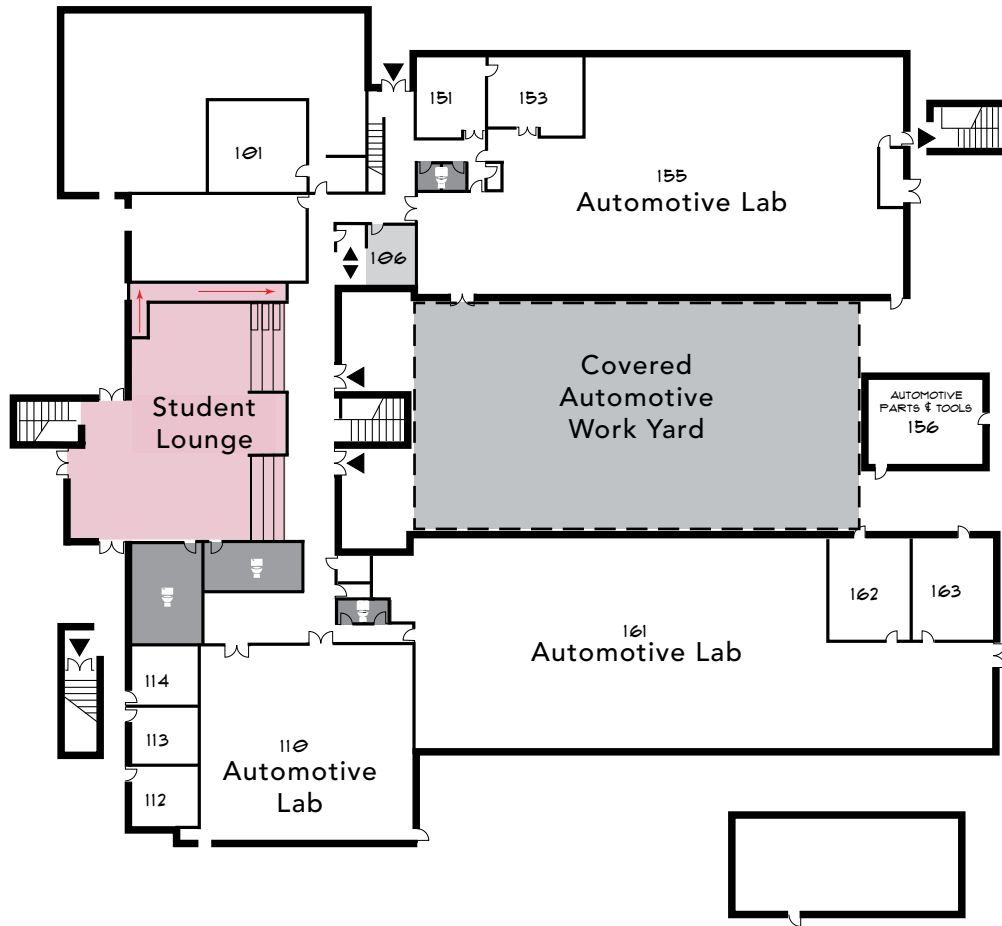



# EAST CAMPUS - OPPORTUNITIES

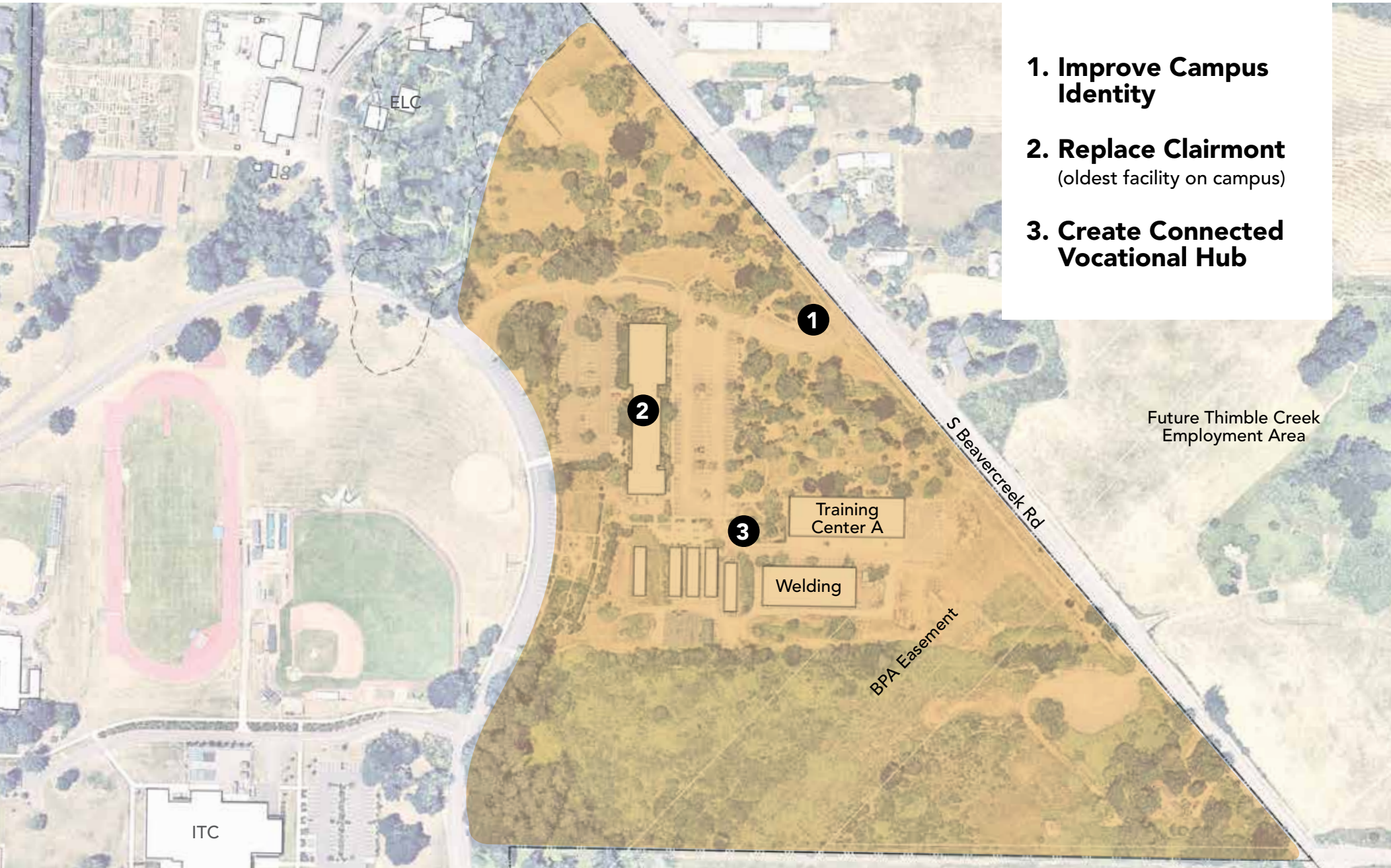

- 1. Improve Campus Identity**
- 2. Replace Clairmont**  
(oldest facility on campus)
- 3. Create Connected Vocational Hub**



# EAST CAMPUS - CAPACITY STUDIES





# EXPLORING AFFORDABLE HOUSING PARTNERSHIPS

Land lease Partnership with third-party affordable housing provider on CCC land



Example: PCC Metro Center Affordable Housing Development

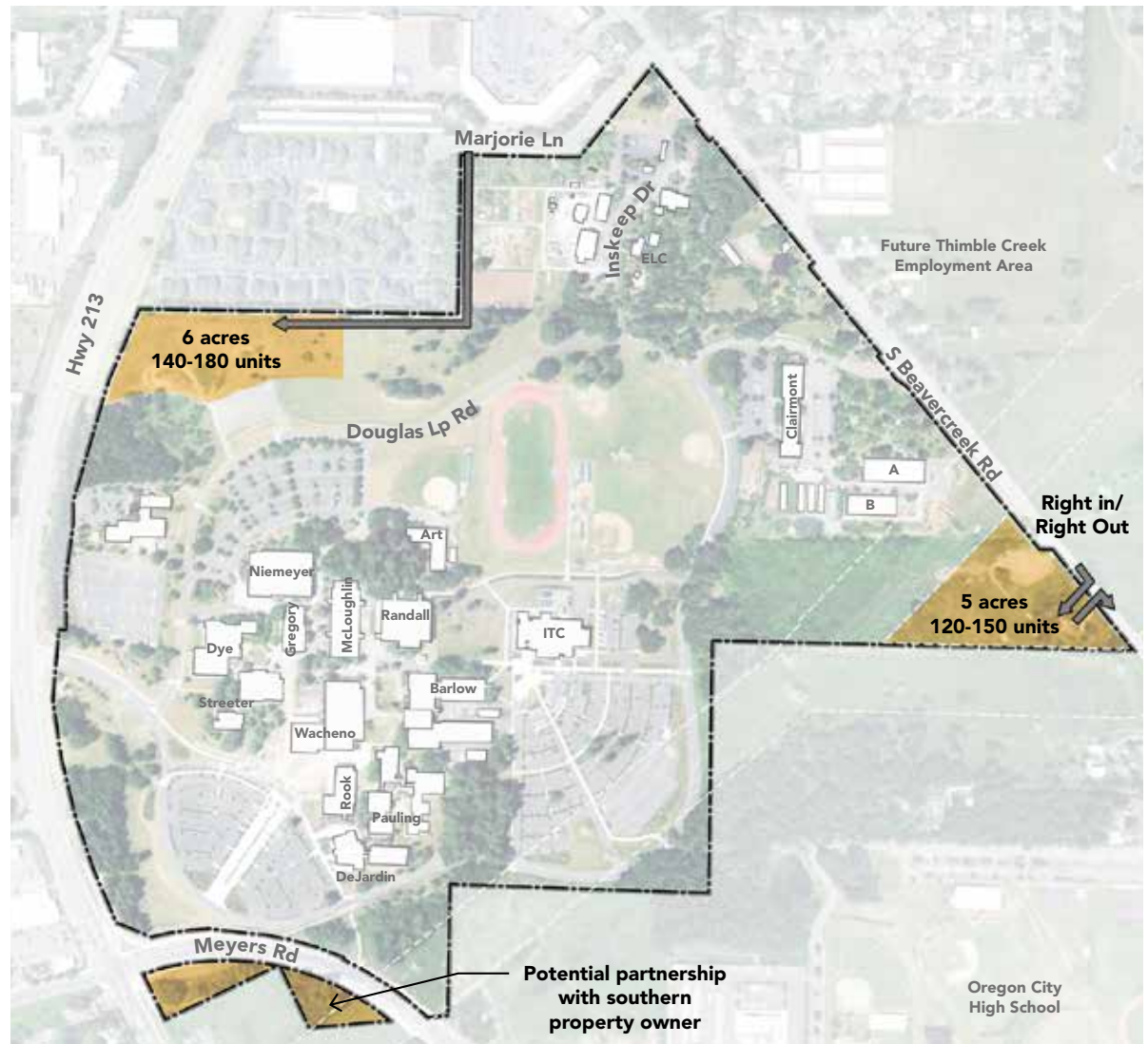

- CAMPUS BOUNDARY
- OPPORTUNITY SITES





# HARMONY CAMPUS



## HARMONY CAMPUS: MASTER PLAN OPPORTUNITIES

- Building Enhancement & Adaptation
- Campus Entry & Pedestrian Improvements
- Open Space Improvements
- Potential Strategic Partnership Sites

## BUILDING ADAPTATION OPPORTUNITIES

### HARMONY WEST

- Food Options
- Improved Indoor-Outdoor Space



### HARMONY EAST

- Meet Existing Program Needs
- Student Amenity Space
- Improved Indoor-Outdoor Space



# OPEN SPACE OPPORTUNITIES

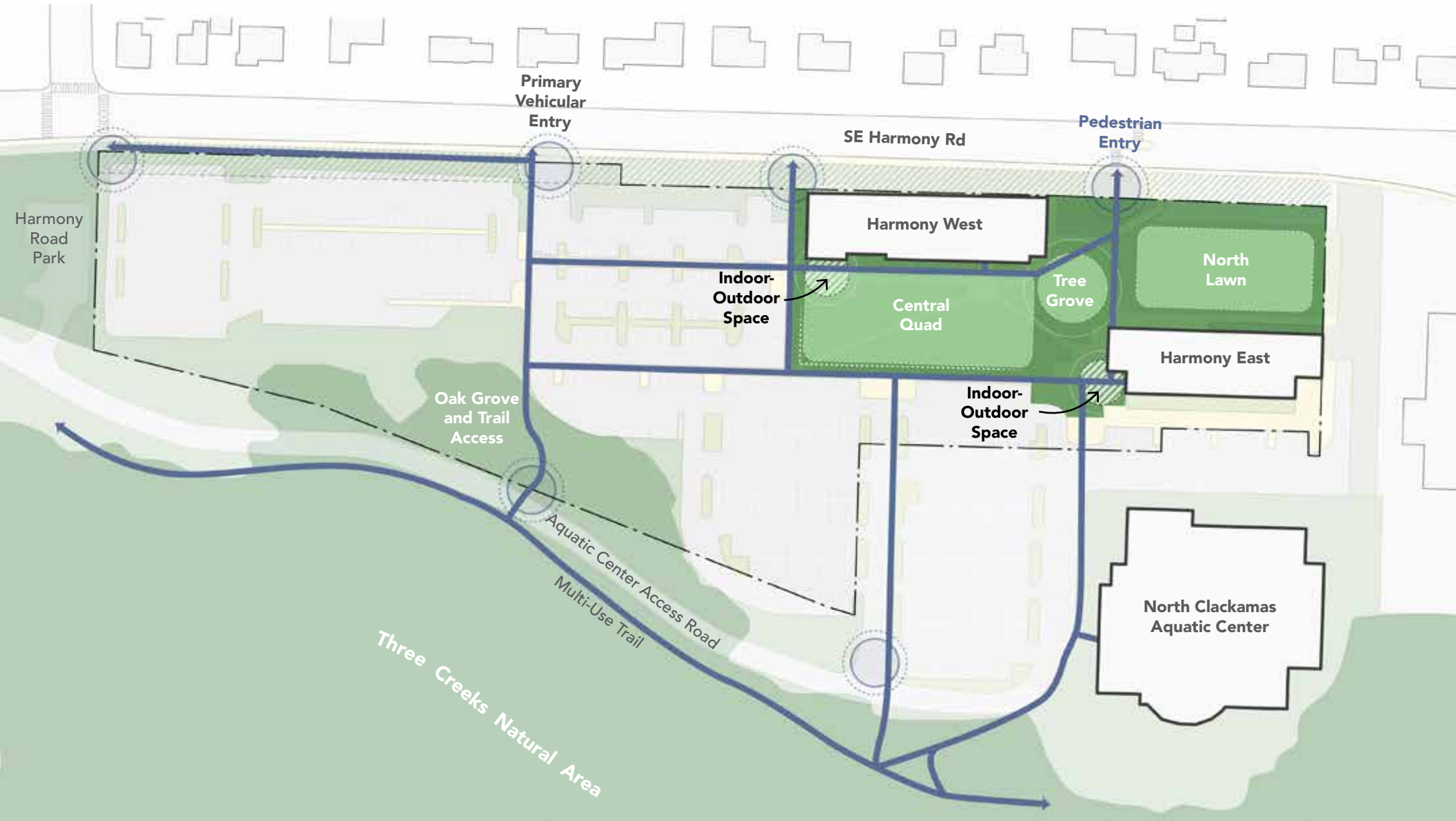

PEDESTRIAN ROUTE



CAMPUS ENTRY



# USABLE OPEN SPACE - EXAMPLES





# OPPORTUNITY SITES

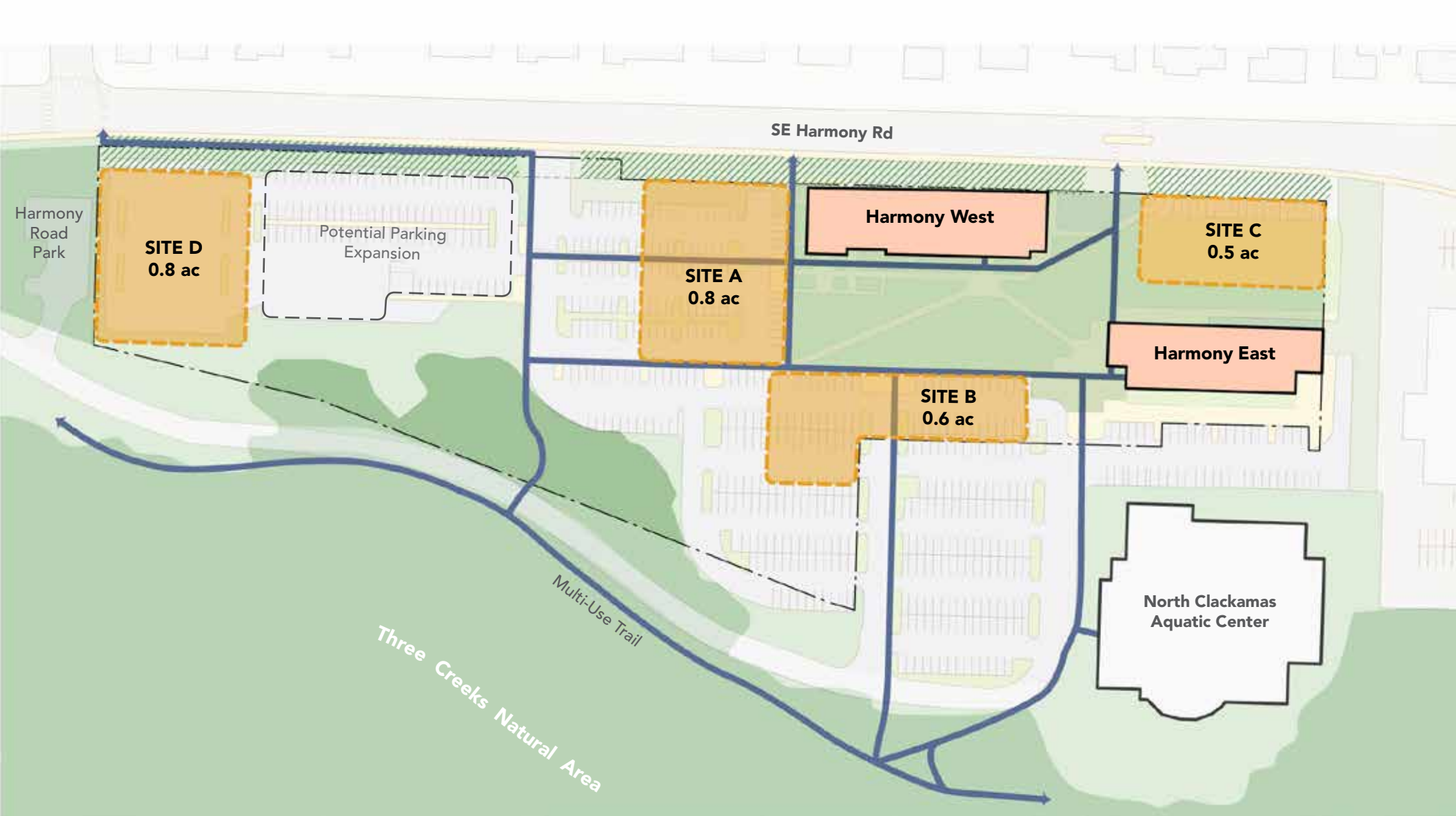

— PEDESTRIAN ROUTE      — OPPORTUNITY SITE

## EXAMPLE: COMMUNITY PARTNERSHIP BUILDING

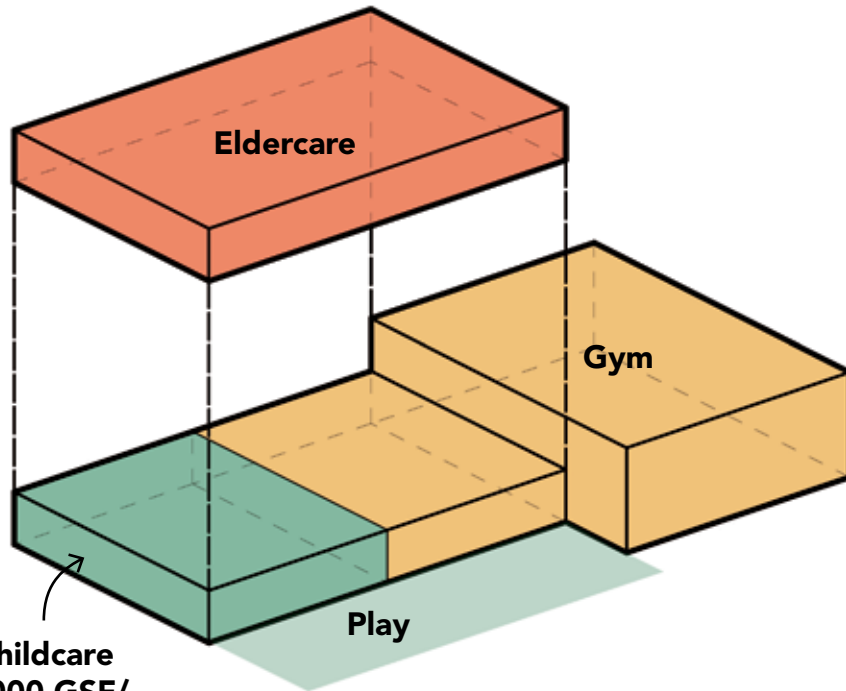

Childcare  
(3000 GSF/  
30 kids)

### Community Building Partnership - 20,000 GSF

- Gym, fitness studios & locker rooms
- Childcare
- Eldercare



# COMMUNITY PARTNERSHIP BUILDING: SITE OPTIONS





## EXAMPLE: HEALTHCARE PARTNERSHIP BUILDING

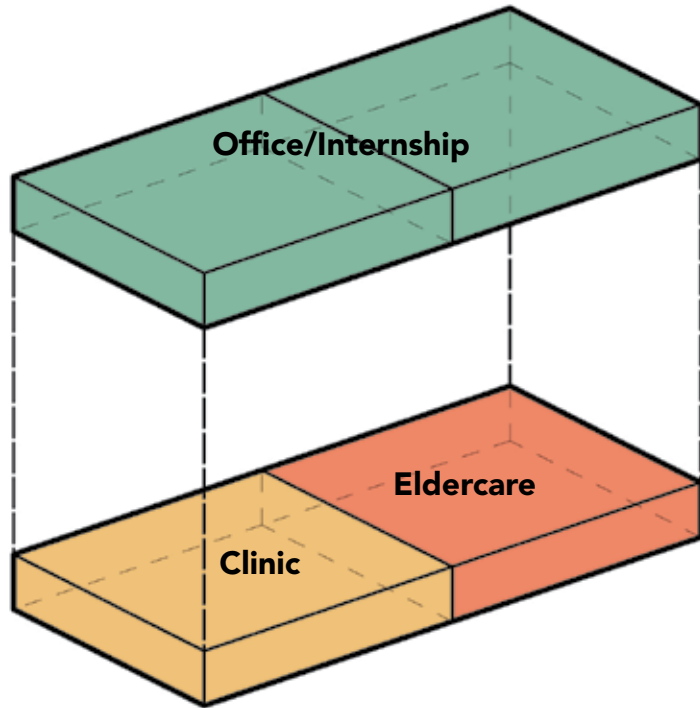

### Healthcare Partnership - 24,000 GSF

- Clinic
- Office
- Elder Care
- Internship



# HEALTHCARE PARTNERSHIP BUILDING: SITE OPTIONS







# WILSONVILLE CAMPUS



# WILSONVILLE CAMPUS: MASTER PLAN OPPORTUNITIES

- Building Adaptation
- Vocational Training Space
- General Education Space
- Potential Strategic Partnership Sites





## BUILDING ADAPTATION OPPORTUNITIES

- Food Options
- Science Lab for General Education
- Student Lounge Space





# VOCATIONAL TRAINING SPACES





# MASTER PLAN OPPORTUNITIES: IF PGE REMAINS



-  Existing Campus Uses
-  Partner Use
-  Opportunity Site

# MASTER PLAN OPPORTUNITIES: LEASED SPACE REPROGRAMMED

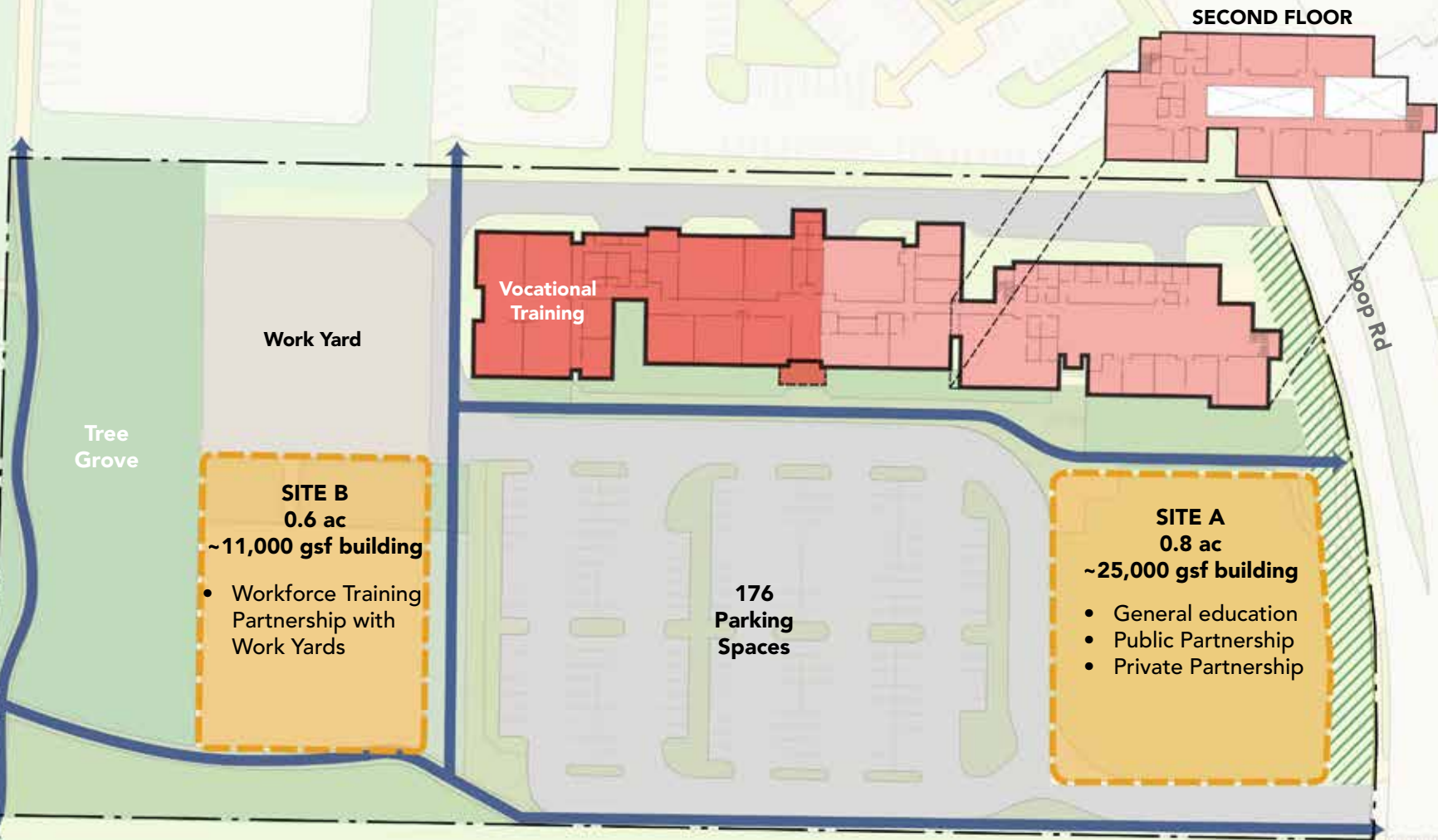



**SITE B**  
0.6 ac  
~11,000 gsf building

- Workforce Training Partnership with Work Yards

**SITE A**  
0.8 ac  
~25,000 gsf building

- General education
- Public Partnership
- Private Partnership

-  Existing Campus Uses
-  Vocational Training
-  Opportunity Site



# PARTNERSHIP/ACADEMIC BUILDING

## Site A

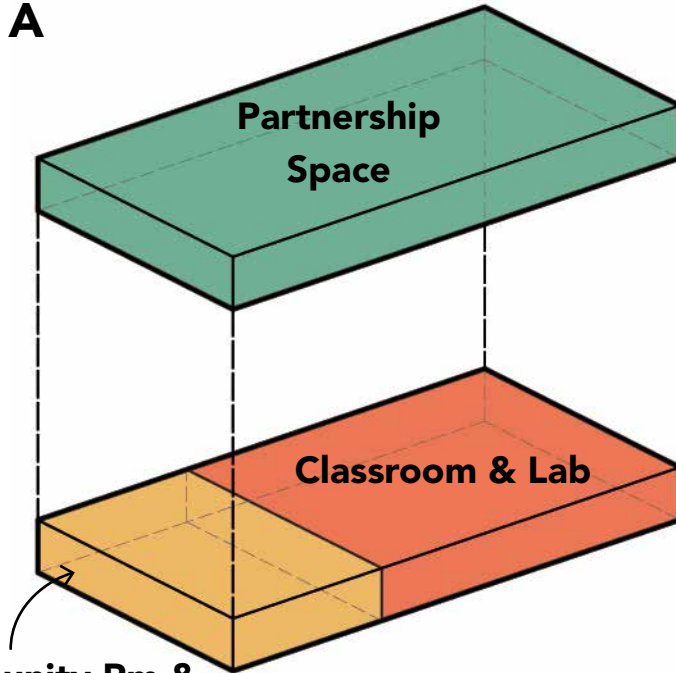

Community Rm &  
Food Options

### Academic & Partnership Building - 25,000 GSF

- Community Room
- Classroom & Labs
- Partnership Space
- No Workyard

## Site B

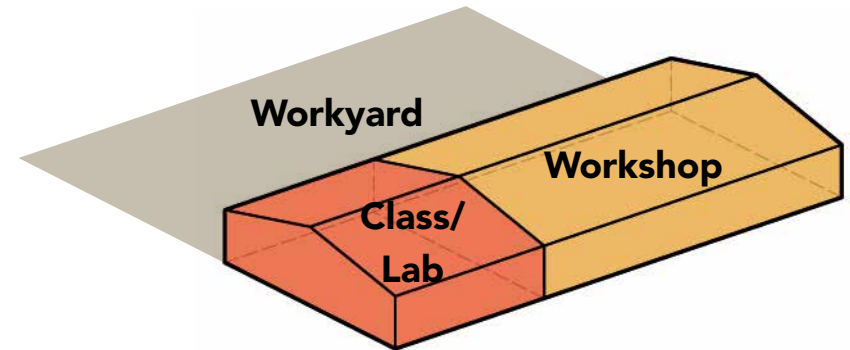

### Partnership Building - 11,000 GSF

- Workyard
- Workshop Space
- Class/Lab

# PARTNERSHIP/ACADEMIC BUILDING

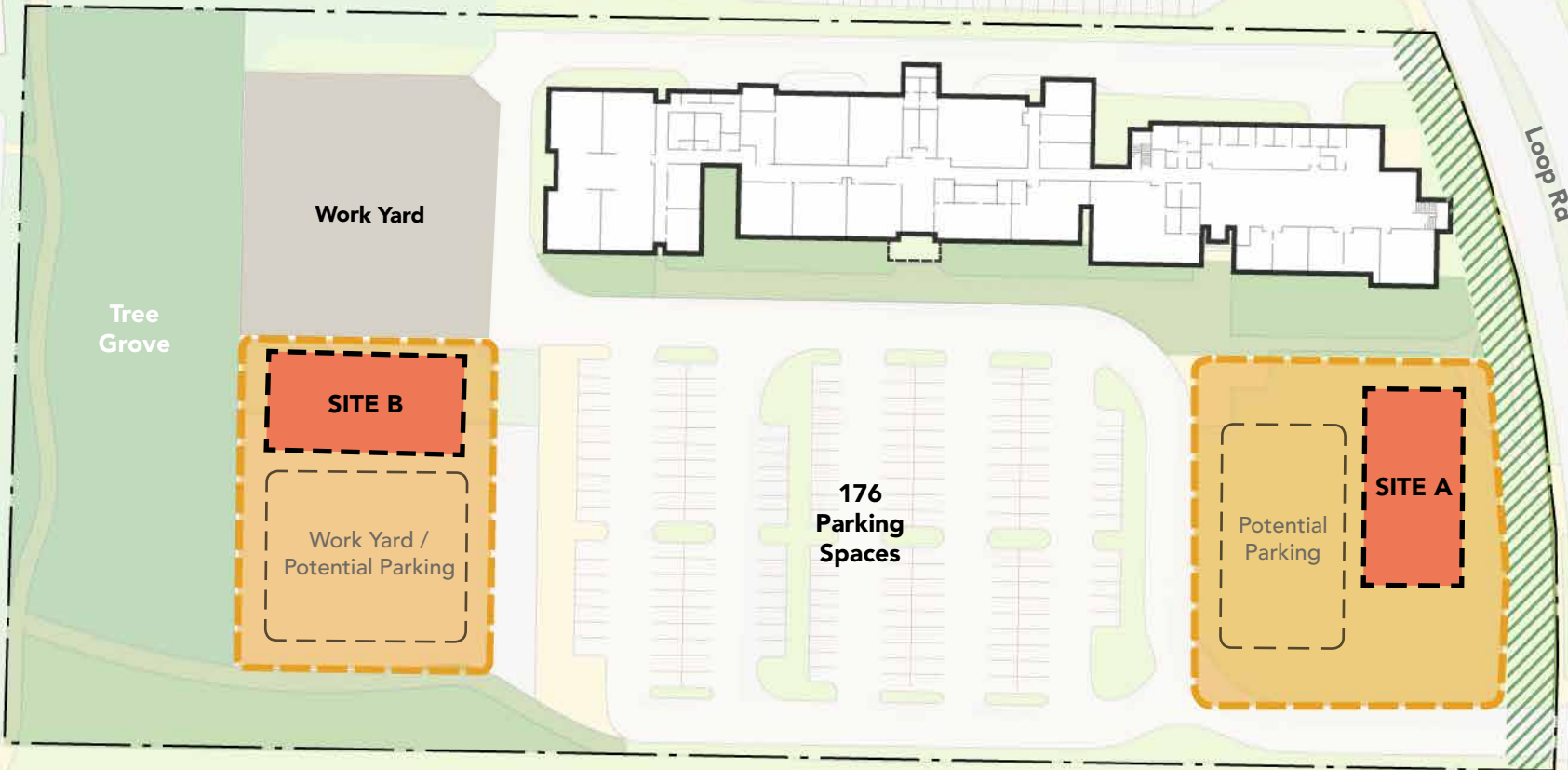



The background of the slide is a photograph of a modern building with a courtyard. The building has a mix of brick and light-colored panels. In the foreground, a group of people is walking on a paved path in the courtyard. The overall scene is bright and clear.

## CONCEPT MASTER PLAN **NEXT STEPS**

- Presidents Council Update
- Final Survey Summary
- Final Concept Master Plan:  
December 2022

**OTHER QUESTIONS OR FEEDBACK?**

**EMAIL: [master.planning@clackamas.edu](mailto:master.planning@clackamas.edu)**